





CL.1 Wall valve anti-clockwise closing hot 1/2" - Chrome

CL.1

36 627 707

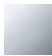

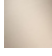
- with CASCADE structure
- rosette 60 x 60 mm
- with hot marking
- head part with cut-to-length spindle and sleeve

| | | |
|---|-------------------------------|---------------|
|  | Chrome | 36 627 707-00 |
|  | Brushed Platinum | 36 627 707-06 |
|  | Dark Chrome | 36 627 707-19 |
|  | Brushed Champagne (22kt Gold) | 36 627 707-46 |
|  | Champagne (22kt Gold) | 36 627 707-47 |
|  | Brushed Dark Platinum | 36 627 707-99 |

Required miscellaneous



- Wall valve 1/2" -** 35 607 970-90
 •max. recess depth 150 mm 0010
 •min. recess depth 105 mm

36 627 707

mm [inches]

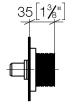

Codes & Standards

ADA

ASME
A112.18.1/CSA
B125.1

Certificates

DVGW_DW-
6501DN0116.

IAPMO_4976 (1).

LGA_29931.

WRAS_2010066.

LGA_29932.

36 627 707

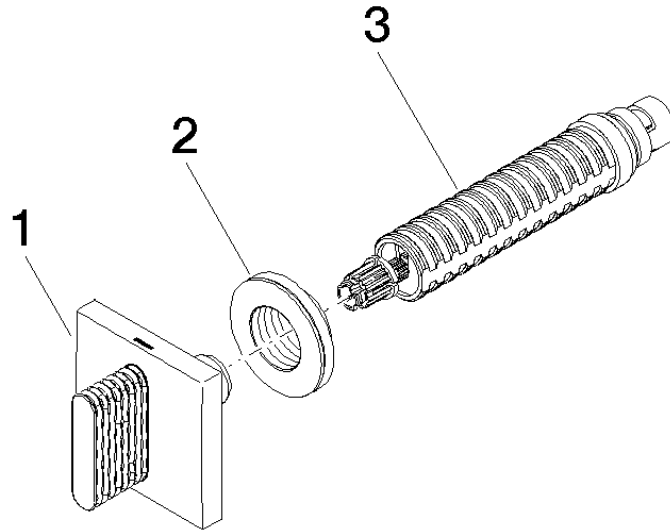

Spare parts list

| No. | Item Number | Name | Quantity used | Delivery time |
|-----|--------------------|----------------|---------------|---------------|
| 1 | 90 20 70 053 03-00 | handle (hot) | 1 | 10 |
| 2 | 09 21 02 108 90 | disc | 1 | 60 |
| 3 | 90 90 03 142 00 90 | top | 1 | 2 |